

Courses & Distances
up the Creek.

S. 73. W. 38
S. 46. W. 50
S. 86. W. 65
<hr/>
153

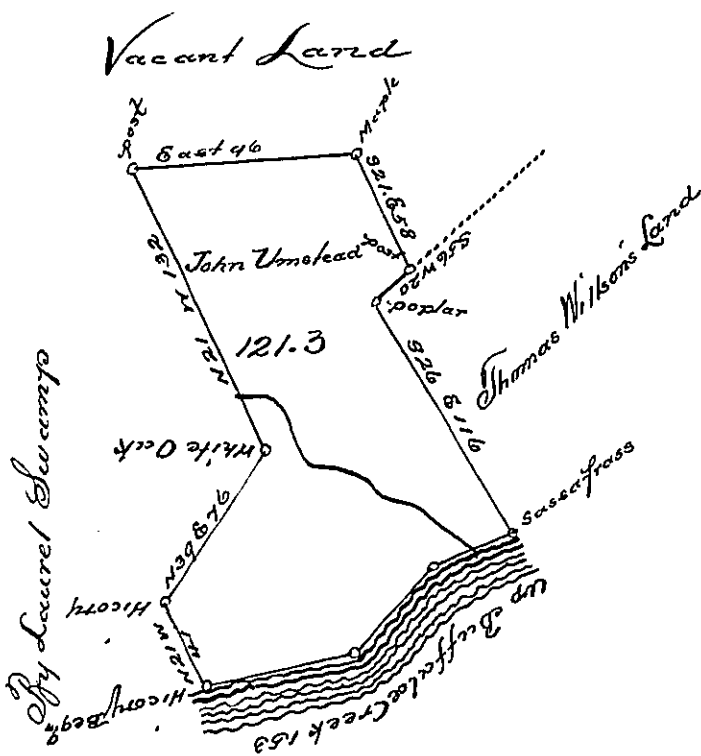

The Draught of a Tract of Land called _____ situate on Buffalo Creek in the County of Berks, containing One Hundred Twentyone acres 60 perches with the usual allowance of six acres of Cent for Roads. Survey'd the 17th day of May Anno Dom. 1770 In Pursuance of an order of survey to John Umstead, Bearing date at Philad^a the 3^d day of April Anno Dom. 1769. N^o 1255.

Wm. Maclay D.S.

To. John Lukens Esqr
S. G. of Pennsylvania

IN TESTIMONY that the above is a copy of the original remaining on file in the Department of Internal Affairs of Pennsylvania, made conformably to an Act of Assembly approved the 16th day of February, 1833, I have hereunto set my Hand and caused the Seal of said Department to be affixed at Harrisburg, this

second day of April, 1895

Isaac P. Pearson
Secretary of Internal Affairs.